



QBE Americas, Inc.

PO Box 975
Sun Prairie, WI 53590 (800) 362-5448

CLAIM NO.: <input type="text"/>		Reinspection <input type="checkbox"/>	INSURED	
Policy No.: Date of Loss: 11/05/2019 6:01 AM Type of Loss: Pipes Burst non Weather Event Deductible: Year Built: Cat No.:		Home phone: Business phone: Mobile phone: Bus. Fax: Contact:		
Insuring Company: Adjuster: Phone: Email:		Loss address:		
Status: Claim Opened Age: 38d 08h Assignees:		Originated: 11/07/2019, 12:15 PM by		
DATES		POLICY IHG1000306-00		
Created: 11/07/2019 Assigned: 11/07/2019 Received: 11/13/2019 Contacted: 11/13/2019 Inspected: 11/18/2019 Estimated: 11/22/2019 Approved: Job Started: Completed: 11/22/2019 Closed:		Policy Type: Commercial Lines Renewed: time(s) Effective from: 09/10/2019 to: 09/10/2020		
Overall risk condition:		Coverage	Limits	Deductible
		Unit 2503		
		Unit 2505		
INITIAL LOSS REPORT				

PropertyContact :

CAUSE

DAMAGES

FIRE SPRINKLER HEAD BREAKS;CEILINGS IN LIVING ROOM AREA HAVE COLLAPSED

GENERAL COMMENTS



QBE

QBE Americas, Inc.

PO Box 975
Sun Prairie, WI 53590 (800) 362-5448

Description	Quantity	Unit Price	Per	RC	Depreciation	ACV
-------------	----------	------------	-----	----	--------------	-----

ESTIMATE: Structure (Sedgwick - Atlanta, GA) Claim

Completed

FLOORPLAN: Unit 2503

General Items

1 Dump Truck, Single Axle, 5 CY	1	\$267.21	LD	\$267.21	\$0.00	\$267.21
---------------------------------	---	----------	----	----------	--------	----------

General Items - Subtotal

\$267.21

Living Room

Length: 16'8"	Width: 13'8"	Height: 8' Flat				
Walls: 456.66 SF	Walls-subs: 300.66 SF	Walls-subs-cas-bsbd: 284.36 SF				
Doors: 40.00 SF	Windows: 0.00 SF	Openings: 116.00 SF	Missing Walls: 28.67 SF			
Floor: 227.78 SF	Ceiling: 227.78 SF	Perim (F): 36.00 LF	Perim (C): 42.58 LF			

2 Base Molding, Paint Grade, 3" to 6" - Replace	36.02 (38.18)	\$3.14	LF	\$117.25	\$5.86 ✓	\$111.39
<input type="checkbox"/> Includes 6% waste on material quantity.						
<input type="checkbox"/> Line items to replace items removed by mitigation company and also original to unit.						
3 Base Molding, 6" & Under - Prime & Paint	36.02	\$1.63	LF	\$58.71	\$14.68 ✓	\$44.03
4 Carpet Pad, Good - Replace	227.78 (239.17)	\$0.60	SF	\$140.31	\$42.09 ✓	\$98.22
<input type="checkbox"/> Includes 5% waste on material quantity.						
5 Carpet, Wall to Wall, Good - Replace	227.78 (250.56)	\$3.64	SF	\$894.05	\$268.22 ✓	\$625.83
<input type="checkbox"/> Includes 10% waste on material quantity.						
6 Drywall Patch 1 to 4 SF	1	\$107.44	EA	\$107.44	\$0.00	\$107.44
7 Drywall/Plaster Ceiling - Paint, 1 Coat	227.78	\$0.60	SF	\$136.66	\$34.17 ✓	\$102.49
<input type="checkbox"/> Paint continuous ceiling from Dining Room.						
8 Final Clean, per SF - Clean	227.78	\$0.17	SF	\$38.72	\$0.00	\$38.72

Living Room - Subtotal

\$1,128.12

Entry

Length: 6'8"	Width: 3'7"	Height: 8' Flat				
Walls: 135.33 SF	Walls-subs: 115.33 SF	Walls-subs-cas-bsbd: 106.55 SF				
Doors: 20.00 SF	Windows: 0.00 SF	Openings: 0.00 SF	Missing Walls: 28.67 SF			
Floor: 23.89 SF	Ceiling: 23.89 SF	Perim (F): 13.34 LF	Perim (C): 16.92 LF			

9 Base Molding, Paint Grade, 3" to 6" - Replace	13.34 (14.14)	\$3.14	LF	\$43.42	\$2.17 ✓	\$41.25
<input type="checkbox"/> Includes 6% waste on material quantity.						
10 Base Molding, 6" & Under - Prime & Paint	13.34	\$1.63	LF	\$21.74	\$5.44 ✓	\$16.30
11 Carpet Pad, Good - Replace	23.89 (25.08)	\$0.60	SF	\$14.72	\$4.42 ✓	\$10.30
<input type="checkbox"/> Includes 5% waste on material quantity.						
12 Carpet, Wall to Wall, Good - Replace	23.89 (26.28)	\$3.64	SF	\$93.77	\$28.13 ✓	\$65.64
<input type="checkbox"/> Includes 10% waste on material quantity.						
13 Drywall/Plaster Ceiling - Paint, 1 Coat	23.89	\$0.60	SF	\$14.34	\$3.59 ✓	\$10.75
14 Final Clean, per SF - Clean	23.89	\$0.17	SF	\$4.07	\$0.00	\$4.07

Claim



QBE

QBE Americas, Inc.

PO Box 975
Sun Prairie, WI 53590 (800) 362-5448

Description	Quantity	Unit Price	Per	RC	Depreciation	ACV
ESTIMATE: Structure (Sedgwick - Atlanta, GA)						
Completed						
Claim						

Entry(con't)

Entry - Subtotal

\$148.31

Hallway

Length: 12' **Width:** 5'6" **Height:** 8' Flat
Walls: 280.00 SF **Walls-subs:** 193.33 SF **Walls-subs-cas-bsbd:** 170.25 SF
Doors: 66.68 SF **Windows:** 0.00 SF **Openings:** 20.00 SF **Missing Walls:** 0.00 SF
Floor: 43.50 SF **Ceiling:** 43.50 SF **Perim (F):** 20.46 LF **Perim (C):** 32.50 LF



15 Base Molding, Paint Grade, 3" to 6" - Replace <input type="checkbox"/> Includes 6% waste on material quantity.	20.46 (21.69)	\$3.14	LF	\$66.60	\$3.33 ✓	\$63.27
16 Base Molding, 6" & Under - Prime & Paint	20.46	\$1.63	LF	\$33.35	\$8.34 ✓	\$25.01
17 Carpet Pad, Good - Replace <input type="checkbox"/> Includes 5% waste on material quantity.	43.50 (45.68)	\$0.60	SF	\$26.80	\$8.04 ✓	\$18.76
18 Carpet, Wall to Wall, Good - Replace <input type="checkbox"/> Includes 10% waste on material quantity.	43.50 (47.85)	\$3.64	SF	\$170.74	\$51.22 ✓	\$119.52
19 Drywall Patch 1 to 4 SF	1	\$107.44	EA	\$107.44	\$0.00	\$107.44
20 Drywall/Plaster Ceiling - Paint, 1 Coat	43.50	\$0.60	SF	\$26.10	\$6.53 ✓	\$19.57
21 Final Clean, per SF - Clean	43.50	\$0.17	SF	\$7.40	\$0.00	\$7.40

Hallway - Subtotal

\$360.97

Dining Room

Length: 14'5" **Width:** 11'9" **Height:** 8' Flat
Walls: 418.66 SF **Walls-subs:** 289.89 SF **Walls-subs-cas-bsbd:** 276.36 SF
Doors: 12.78 SF **Windows:** 0.00 SF **Openings:** 116.00 SF **Missing Walls:** 0.00 SF
Floor: 147.65 SF **Ceiling:** 147.65 SF **Perim (F):** 35.55 LF **Perim (C):** 37.84 LF

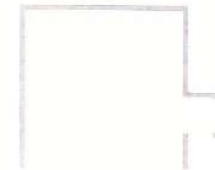

22 Base Molding, Paint Grade, 3" to 6" - Replace <input type="checkbox"/> Includes 6% waste on material quantity.	35.55 (37.68)	\$3.14	LF	\$115.72	\$5.79 ✓	\$109.93
23 Base Molding, 6" & Under - Prime & Paint	35.55	\$1.63	LF	\$57.95	\$14.49 ✓	\$43.46
24 Carpet Pad, Good - Replace <input type="checkbox"/> Includes 5% waste on material quantity.	147.65 (155.03)	\$0.60	SF	\$90.95	\$27.29 ✓	\$63.66
25 Carpet, Wall to Wall, Good - Replace <input type="checkbox"/> Includes 10% waste on material quantity.	147.65 (162.42)	\$3.64	SF	\$579.54	\$173.86 ✓	\$405.68
26 Drywall Patch 1 to 4 SF <input type="checkbox"/> Line item to repair hole in ceiling from sprinkler head.	1	\$107.44	EA	\$107.44	\$0.00	\$107.44
27 Spot Prime, Ceiling, Up to 32 SF	1	\$19.24	EA	\$19.24	\$0.00	\$19.24
28 Drywall/Plaster Ceiling - Paint, 1 Coat	147.65	\$0.60	SF	\$88.59	\$22.15 ✓	\$66.44
29 Drywall/Plaster Wall - Paint, 1 Coat	276.36	\$0.50	SF	\$138.18	\$34.55 ✓	\$103.63
30 Final Clean, per SF - Clean	147.65	\$0.17	SF	\$25.11	\$0.00	\$25.11

Claim



QBE

QBE Americas, Inc.

PO Box 975
Sun Prairie, WI 53590 (800) 362-5448

Description	Quantity	Unit Price	Per	RC	Depreciation	ACV
ESTIMATE: Structure (Sedgwick - Atlanta, GA)						
Claim						
<input type="checkbox"/> Completed						

Dining Room(con't)

Dining Room - Subtotal

\$944.59

Pantry

Length: 2'1" **Width:** 2'1" **Height:** 8' Flat

Walls: 66.68 SF **Walls-subs:** 53.90 SF **Walls-subs-cas-bsbd:** 50.35 SF

Doors: 12.78 SF **Windows:** 0.00 SF **Openings:** 0.00 SF **Missing Walls:** 0.00 SF

Floor: 4.34 SF **Ceiling:** 4.34 SF **Perim (F):** 6.24 LF **Perim (C):** 8.32 LF

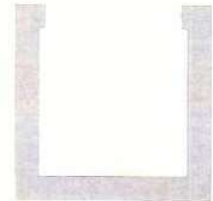

31 Base Molding, Paint Grade, 3" to 6" - Replace	6.24 (6.61)	\$3.14	LF	\$20.30	\$1.02 ✓	\$19.28
<input type="checkbox"/> Includes 6% waste on material quantity.						
32 Base Molding, 6" & Under - Prime & Paint	6.24	\$1.63	LF	\$10.17	\$2.54 ✓	\$7.63
33 Vinyl Sheet Flooring (Low VOC) Good - Replace	4.34 (4.77)	\$5.43	SF	\$25.44	\$3.05 ✓	\$22.39
<input type="checkbox"/> Includes 10% waste on material quantity.						
34 Floor Prep, Sheet Goods Standard	4.34	\$1.01	SF	\$4.38	\$0.00	\$4.38
35 Final Clean, per SF - Clean	4.34	\$0.17	SF	\$0.73	\$0.00	\$0.73

Pantry - Subtotal

\$54.41

Kitchen

Length: 11'4" **Width:** 11'9" **Height:** 8' Flat

Walls: 369.33 SF **Walls-subs:** 337.33 SF **Walls-subs-cas-bsbd:** 320.17 SF

Doors: 0.00 SF **Windows:** 12.00 SF **Openings:** 20.00 SF **Missing Walls:** 0.00 SF

Floor: 119.88 SF **Ceiling:** 119.88 SF **Perim (F):** 43.67 LF **Perim (C):** 43.67 LF

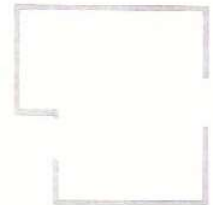

36 Vinyl Sheet Flooring (Low VOC) Good - Replace	119.88 (131.87)	\$5.43	SF	\$703.34	\$84.40 ✓	\$618.94
<input type="checkbox"/> Includes 10% waste on material quantity.						
37 Floor Prep, Sheet Goods Standard	119.88	\$1.01	SF	\$121.08	\$0.00	\$121.08
38 Base Molding, Paint Grade, 3" to 6" - Replace	20.67 (21.91)	\$3.14	LF	\$67.29	\$3.36 ✓	\$63.93
<input type="checkbox"/> Includes 6% waste on material quantity.						
39 Base Molding, 6" & Under - Prime & Paint	23.09	\$1.63	LF	\$37.64	\$9.41 ✓	\$28.23
40 Drywall/Plaster Ceiling - Paint, 1 Coat	119.88	\$0.60	SF	\$71.93	\$17.98 ✓	\$53.95
41 Final Clean, per SF - Clean	119.88	\$0.17	SF	\$20.39	\$0.00	\$20.39

Kitchen - Subtotal

\$906.52



Description	Quantity	Unit Price	Per	RC	Depreciation	ACV
-------------	----------	------------	-----	----	--------------	-----

ESTIMATE: Structure (Sedgwick - Atlanta, GA) Claim

Completed

Closet

Length: 2'6" **Width:** 2'2" **Height:** 8' Flat
Walls: 74.66 SF **Walls-sub:** 59.66 SF **Walls-sub-cas-bsbd:** 55.27 SF
Doors: 15.00 SF **Windows:** 0.00 SF **Openings:** 0.00 SF **Missing Walls:** 0.00 SF
Floor: 5.42 SF **Ceiling:** 5.42 SF **Perim (F):** 6.84 LF **Perim (C):** 9.34 LF

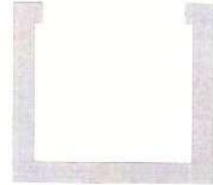

42 Base Molding, Paint Grade, 3" to 6" - Replace <input type="checkbox"/> Includes 6% waste on material quantity.	6.84 (7.25)	\$3.14	LF	\$22.26	\$1.11 ✓	\$21.15
43 Base Molding, 6" & Under - Prime & Paint	6.84	\$1.63	LF	\$11.15	\$2.79 ✓	\$8.36
44 Carpet Pad, Good - Replace <input type="checkbox"/> Includes 5% waste on material quantity.	5.42 (5.69)	\$0.60	SF	\$3.34	\$1.00 ✓	\$2.34
45 Carpet, Wall to Wall, Good - Replace <input type="checkbox"/> Includes 10% waste on material quantity.	5.42 (5.96)	\$3.64	SF	\$21.27	\$6.38 ✓	\$14.89
46 Final Clean, per SF - Clean	5.42	\$0.17	SF	\$0.92	\$0.00	\$0.92

Closet - Subtotal

\$47.66

Storage Closet

Length: 5'10" **Width:** 8'6" **Height:** 8' Flat
Walls: 229.34 SF **Walls-sub:** 212.67 SF **Walls-sub-cas-bsbd:** 200.42 SF
Doors: 16.67 SF **Windows:** 0.00 SF **Openings:** 0.00 SF **Missing Walls:** 0.00 SF
Floor: 49.58 SF **Ceiling:** 49.58 SF **Perim (F):** 25.58 LF **Perim (C):** 28.66 LF



47 Base Molding, Paint Grade, 3" to 6" - Replace <input type="checkbox"/> Includes 6% waste on material quantity.	25.58 (27.11)	\$3.14	LF	\$83.26	\$4.16 ✓	\$79.10
48 Base Molding, 6" & Under - Prime & Paint	25.58	\$1.63	LF	\$41.70	\$10.43 ✓	\$31.27
49 Vinyl Sheet Flooring (Low VOC) Good - Replace <input type="checkbox"/> Includes 10% waste on material quantity.	49.58 (54.54)	\$5.43	SF	\$290.89	\$34.91 ✓	\$255.98
50 Floor Prep, Sheet Goods Standard	49.58	\$1.01	SF	\$50.07	\$0.00	\$50.07
51 Water Heater, Electric (MH) 40 Gallon - Rem/Reset	1	\$175.70	EA	\$175.70	\$0.00	\$175.70
52 Final Clean, per SF - Clean	49.58	\$0.17	SF	\$8.43	\$0.00	\$8.43

Storage Closet - Subtotal

\$600.55

Utility Room

Length: 5'10" **Width:** 8'6" **Height:** 8' Flat
Walls: 229.34 SF **Walls-sub:** 212.67 SF **Walls-sub-cas-bsbd:** 200.42 SF
Doors: 16.67 SF **Windows:** 0.00 SF **Openings:** 0.00 SF **Missing Walls:** 0.00 SF
Floor: 49.58 SF **Ceiling:** 49.58 SF **Perim (F):** 25.58 LF **Perim (C):** 28.66 LF





QBE

QBE Americas, Inc.

PO Box 975
Sun Prairie, WI 53590 (800) 362-5448

Description	Quantity	Unit Price	Per	RC	Depreciation	ACV
ESTIMATE: Structure (Sedgwick - Atlanta, GA)						
Claim						
<input type="checkbox"/> Completed						

Utility Room(con't)

53 Drywall Patch 1 to 4 SF	1	\$107.44	EA	\$107.44	\$0.00	\$107.44
54 Base Molding, Paint Grade, 3" to 6" - Replace	25.58 (27.11)	\$3.14	LF	\$83.26	\$4.16 ✓	\$79.10
<input type="checkbox"/> Includes 6% waste on material quantity.						
55 Base Molding, 6" & Under - Prime & Paint	25.58	\$1.63	LF	\$41.70	\$10.43 ✓	\$31.27
56 Cabinet Toe Kick Veneer Wrapped - Replace	3.00	\$4.69	LF	\$14.07	\$2.81 ✓	\$11.26
57 Toilet/Water Closet 1 Piece, Good - Rem/Reset	1	\$154.48	EA	\$154.48	\$0.00	\$154.48
58 Final Clean, per SF - Clean	49.58	\$0.17	SF	\$8.43	\$0.00	\$8.43
Utility Room - Subtotal						\$391.98

Master Bed

Length: 11' **Width:** 18'11" **Height:** 8' Flat
Walls: 478.69 SF **Walls-subs:** 404.68 SF **Walls-subs-cas-bsbd:** 366.71 SF
Doors: 50.01 SF **Windows:** 24.00 SF **Openings:** 0.00 SF **Missing Walls:** 0.00 SF
Floor: 174.86 SF **Ceiling:** 174.86 SF **Perim (F):** 50.57 LF **Perim (C):** 59.81 LF



59 Carpet Pad, Good - Replace	32.00 (33.60)	\$0.60	SF	\$19.71	\$5.91 ✓	\$13.80
<input type="checkbox"/> Includes 5% waste on material quantity.						
60 Install Carpet Only	174.86	\$0.82	SF	\$143.39	\$0.00	\$143.39
61 Carpet Floor, Shampoo - Clean	174.86	\$0.34	SF	\$59.46	\$0.00	\$59.46
62 Final Clean, per SF - Clean	174.86	\$0.17	SF	\$29.72	\$0.00	\$29.72
Master Bed - Subtotal						\$246.37

Unit 2503 - Subtotal

\$5,096.69

FLOORPLAN: Unit 2505

General Items

63 Dump Truck, Single Axle, 5 CY	1	\$267.21	LD	\$267.21	\$0.00	\$267.21
64 Bid Item, Mitigation	272.73	\$0.00	EA	\$0.00	\$0.00	\$0.00
<input type="checkbox"/> Line item for mitigation invoice on file from ServPro for unit 2505.						
General Items - Subtotal						\$267.21

Dining Room

Length: 14'5" **Width:** 11'9" **Height:** 8' Flat
Walls: 418.67 SF **Walls-subs:** 289.90 SF **Walls-subs-cas-bsbd:** 276.36 SF
Doors: 12.78 SF **Windows:** 0.00 SF **Openings:** 116.00 SF **Missing Walls:** 0.00 SF
Floor: 148.45 SF **Ceiling:** 148.45 SF **Perim (F):** 35.54 LF **Perim (C):** 37.83 LF

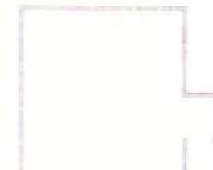

65 Drywall, Ceiling 1/2", Taped - Replace	148.45 (155.87)	\$2.25	SF	\$337.35	\$0.00	\$337.35
<input type="checkbox"/> Includes 5% waste on material quantity.						
66 Drywall, Wall 1/2", Taped - Replace	289.90 (307.29)	\$2.08	SF	\$610.82	\$0.00	\$610.82

Claim



QBE

QBE Americas, Inc.

PO Box 975
Sun Prairie, WI 53590 (800) 362-5448

Description	Quantity	Unit Price	Per	RC	Depreciation	ACV
ESTIMATE: Structure (Sedgwick - Atlanta, GA) Claim						
<input type="checkbox"/> Completed						
<input type="checkbox"/> Includes 6% waste on material quantity.						
67 Texture, Ceiling Stipple - Replace	148.45	\$0.89	SF	\$132.12	\$0.00	\$132.12
68 Base Molding, Paint Grade, 3" to 6" - Replace	35.54 (37.67)	\$3.14	LF	\$115.69	\$5.78 ✓	\$109.91
<input type="checkbox"/> Includes 6% waste on material quantity.						
69 Base Molding, 6" & Under - Prime & Paint	35.54	\$1.63	LF	\$57.93	\$14.48 ✓	\$43.45
70 Drywall/Plaster Ceiling - Prime	148.45	\$0.57	SF	\$84.62	\$0.00	\$84.62
71 Drywall/Plaster Ceiling - Paint, 1 Coat	148.45	\$0.60	SF	\$89.07	\$22.27 ✓	\$66.80
72 Drywall/Plaster Wall - Prime	276.36	\$0.48	SF	\$132.66	\$0.00	\$132.66
73 Drywall/Plaster Wall - Paint, 1 Coat	276.36	\$0.50	SF	\$138.18	\$34.55 ✓	\$103.63
74 Carpet Pad, Good - Replace	148.45 (155.87)	\$0.60	SF	\$91.45	\$27.44 ✓	\$64.01
<input type="checkbox"/> Includes 5% waste on material quantity.						
75 Carpet, Wall to Wall, Good - Replace	148.45 (163.30)	\$3.64	SF	\$582.69	\$174.81 ✓	\$407.88
<input type="checkbox"/> Includes 10% waste on material quantity.						
76 Insulation, Wall, Batt, Unfaced 6" - Replace	96.00	\$0.92	SF	\$88.32	\$0.00	\$88.32
77 Chandelier Good - Remove	1	\$20.62	EA	\$20.62	\$0.00	\$20.62
78 Chandelier Good - Replace	1	\$384.20	EA	\$384.20	\$59.09 ✓	\$325.11
79 Casing, Paint Grade, 3" to 5" - Replace	16.21 (17.02)	\$3.08	LF	\$51.40	\$5.14 ✓	\$46.26
<input type="checkbox"/> Includes 5% waste on material quantity.						
80 Casing - Prime & Paint	16.21	\$1.42	LF	\$23.02	\$5.76 ✓	\$17.26
81 Final Clean, per SF - Clean	148.45	\$0.17	SF	\$25.23	\$0.00	\$25.23
Dining Room - Subtotal						\$2,616.05

Living Room

Length: 16'8" **Width:** 13'8" **Height:** 8' Flat
Walls: 456.66 SF **Walls-subs:** 280.66 SF **Walls-subs-cas-bsbd:** 265.08 SF
Doors: 40.00 SF **Windows:** 0.00 SF **Openings:** 136.00 SF **Missing Walls:** 28.67 SF
Floor: 227.78 SF **Ceiling:** 227.78 SF **Perim (F):** 33.50 LF **Perim (C):** 40.08 LF



82 Drywall, Wall 1/2", Taped - Replace	280.66 (297.50)	\$2.08	SF	\$591.36	\$0.00	\$591.36
<input type="checkbox"/> Includes 6% waste on material quantity.						
83 Drywall, Ceiling 1/2", Taped - Replace	227.78 (239.17)	\$2.25	SF	\$517.63	\$0.00	\$517.63
<input type="checkbox"/> Includes 5% waste on material quantity.						
84 Texture, Ceiling Stipple - Replace	227.78	\$0.89	SF	\$202.73	\$0.00	\$202.73
85 Base Molding, Paint Grade, 3" to 6" - Replace	33.52 (35.53)	\$3.14	LF	\$109.11	\$5.46 ✓	\$103.65
<input type="checkbox"/> Includes 6% waste on material quantity.						
86 Base Molding, 6" & Under - Prime & Paint	33.52	\$1.63	LF	\$54.64	\$13.66 ✓	\$40.98
87 Drywall/Plaster Ceiling - Prime	227.78	\$0.57	SF	\$129.83	\$0.00	\$129.83
88 Drywall/Plaster Ceiling - Paint, 1 Coat	227.78	\$0.60	SF	\$136.66	\$34.17 ✓	\$102.49
89 Drywall/Plaster Wall - Prime	265.08	\$0.48	SF	\$127.24	\$0.00	\$127.24
90 Drywall/Plaster Wall - Paint, 1 Coat	265.08	\$0.50	SF	\$132.54	\$33.14 ✓	\$99.40
91 Carpet Pad, Good - Replace	227.78 (239.17)	\$0.60	SF	\$140.31	\$42.09 ✓	\$98.22

Claim



QBE

QBE Americas, Inc.

PO Box 975
Sun Prairie, WI 53590 (800) 362-5448

Description	Quantity	Unit Price	Per	RC	Depreciation	ACV
ESTIMATE: Structure (Sedgwick - Atlanta, GA)						
Claim						
<input type="checkbox"/> Completed						
<input type="checkbox"/> Includes 5% waste on material quantity.						
92 Carpet, Wall to Wall, Good - Replace	227.78 (250.56)	\$3.64	SF	\$894.05	\$268.22 ✓	\$625.83
<input type="checkbox"/> Includes 10% waste on material quantity.						
93 Fireplace Mantel Pre-fabricated, Good - Replace	4.60	\$48.01	LF	\$220.84	\$88.34 ✓	\$132.50
94 Fireplace Mantel - Prime & Paint	4.60	\$2.05	LF	\$9.43	\$2.36 ✓	\$7.07
95 Casing, Paint Grade, 3" to 5" - Replace	20.50 (21.53)	\$3.08	LF	\$65.01	\$6.50 ✓	\$58.51
<input type="checkbox"/> Includes 5% waste on material quantity.						
96 Casing - Prime & Paint	20.50	\$1.42	LF	\$29.12	\$7.28 ✓	\$21.84
97 Final Clean, per SF - Clean	227.78	\$0.17	SF	\$38.72	\$0.00	\$38.72
Living Room - Subtotal						\$2,898.00

Entry

Length: 6'8" **Width:** 3'7" **Height:** 8' Flat
Walls: 135.33 SF **Walls-subs:** 115.33 SF **Walls-subs-cas-bsbd:** 106.55 SF
Doors: 20.00 SF **Windows:** 0.00 SF **Openings:** 0.00 SF **Missing Walls:** 28.67 SF
Floor: 23.89 SF **Ceiling:** 23.89 SF **Perim (F):** 13.34 LF **Perim (C):** 16.92 LF

98 Drywall, Wall 1/2", Taped - Replace	115.33 (122.25)	\$2.08	SF	\$243.00	\$0.00	\$243.00
<input type="checkbox"/> Includes 6% waste on material quantity.						
<input type="checkbox"/> Line items to replace items removed by mitigation company and also original to unit.						
99 Drywall, Ceiling 1/2", Taped - Replace	23.89 (25.08)	\$2.25	SF	\$54.29	\$0.00	\$54.29
<input type="checkbox"/> Includes 5% waste on material quantity.						
100 Texture, Ceiling Stipple - Replace	23.89	\$0.89	SF	\$21.27	\$0.00	\$21.27
101 Base Molding, Paint Grade, 3" to 6" - Replace	13.34 (14.14)	\$3.14	LF	\$43.42	\$2.17 ✓	\$41.25
<input type="checkbox"/> Includes 6% waste on material quantity.						
102 Base Molding, 6" & Under - Prime & Paint	13.34	\$1.63	LF	\$21.74	\$5.44 ✓	\$16.30
103 Drywall/Plaster Ceiling - Prime	23.89	\$0.57	SF	\$13.62	\$0.00	\$13.62
104 Drywall/Plaster Ceiling - Paint, 1 Coat	23.89	\$0.60	SF	\$14.34	\$3.59 ✓	\$10.75
105 Drywall/Plaster Wall - Prime	106.55	\$0.48	SF	\$51.15	\$0.00	\$51.15
106 Drywall/Plaster Wall - Paint, 1 Coat	106.55	\$0.50	SF	\$53.28	\$13.32 ✓	\$39.96
107 Carpet Pad, Good - Replace	23.89 (25.08)	\$0.60	SF	\$14.72	\$4.42 ✓	\$10.30
<input type="checkbox"/> Includes 5% waste on material quantity.						
108 Carpet, Wall to Wall, Good - Replace	23.89 (26.28)	\$3.64	SF	\$93.77	\$28.13 ✓	\$65.64
<input type="checkbox"/> Includes 10% waste on material quantity.						
109 Casing, Paint Grade, 3" to 5" - Replace	17.50 (18.38)	\$3.08	LF	\$55.50	\$5.55 ✓	\$49.95
<input type="checkbox"/> Includes 5% waste on material quantity.						
110 Casing - Prime & Paint	17.50	\$1.42	LF	\$24.86	\$6.22 ✓	\$18.64
111 Final Clean, per SF - Clean	23.89	\$0.17	SF	\$4.07	\$0.00	\$4.07
Entry - Subtotal						\$640.19



QBE

QBE Americas, Inc.

PO Box 975
Sun Prairie, WI 53590 (800) 362-5448

Description	Quantity	Unit Price	Per	RC	Depreciation	ACV
-------------	----------	------------	-----	----	--------------	-----

ESTIMATE: Structure (Sedgwick - Atlanta, GA) Claim

Completed

Hallway

Length: 12' **Width:** 5'6" **Height:** 8' Flat
Walls: 280.00 SF **Walls-sub:** 193.33 SF **Walls-sub-cas-bsbd:** 170.25 SF
Doors: 66.68 SF **Windows:** 0.00 SF **Openings:** 20.00 SF **Missing Walls:** 0.00 SF
Floor: 43.50 SF **Ceiling:** 43.50 SF **Perim (F):** 20.46 LF **Perim (C):** 32.50 LF



112 Drywall, Wall 1/2", Taped - Replace	193.33 (204.93)	\$2.08	SF	\$407.35	\$0.00	\$407.35
<input type="checkbox"/> Includes 6% waste on material quantity.						
113 Drywall, Ceiling 1/2", Taped - Replace	43.50 (45.68)	\$2.25	SF	\$98.86	\$0.00	\$98.86
<input type="checkbox"/> Includes 5% waste on material quantity.						
114 Texture, Ceiling Stipple - Replace	43.50	\$0.89	SF	\$38.73	\$0.00	\$38.73
115 Base Molding, Paint Grade, 3" to 6" - Replace	20.46 (21.69)	\$3.14	LF	\$66.60	\$3.33 ✓	\$63.27
<input type="checkbox"/> Includes 6% waste on material quantity.						
116 Base Molding, 6" & Under - Prime & Paint	20.46	\$1.63	LF	\$33.35	\$8.34 ✓	\$25.01
117 Drywall/Plaster Ceiling - Prime	43.50	\$0.57	SF	\$24.80	\$0.00	\$24.80
118 Drywall/Plaster Ceiling - Paint, 1 Coat	43.50	\$0.60	SF	\$26.10	\$6.53 ✓	\$19.57
119 Drywall/Plaster Wall - Prime	170.25	\$0.48	SF	\$81.72	\$0.00	\$81.72
120 Drywall/Plaster Wall - Paint, 1 Coat	170.25	\$0.50	SF	\$85.12	\$21.28 ✓	\$63.84
121 Carpet Pad, Good - Replace	43.50 (45.68)	\$0.60	SF	\$26.80	\$8.04 ✓	\$18.76
<input type="checkbox"/> Includes 5% waste on material quantity.						
122 Carpet, Wall to Wall, Good - Replace	43.50 (47.85)	\$3.64	SF	\$170.74	\$51.22 ✓	\$119.52
<input type="checkbox"/> Includes 10% waste on material quantity.						
123 Casing, Paint Grade, 3" to 5" - Replace	67.71 (71.10)	\$3.08	LF	\$214.71	\$21.47 ✓	\$193.24
<input type="checkbox"/> Includes 5% waste on material quantity.						
124 Casing - Prime & Paint	67.71	\$1.42	LF	\$96.14	\$24.04 ✓	\$72.10
125 Final Clean, per SF - Clean	43.50	\$0.17	SF	\$7.40	\$0.00	\$7.40

Hallway - Subtotal

\$1,234.17

Pantry

Length: 2'1" **Width:** 1'9" **Height:** 8' Flat
Walls: 61.34 SF **Walls-sub:** 48.56 SF **Walls-sub-cas-bsbd:** 45.21 SF
Doors: 12.78 SF **Windows:** 0.00 SF **Openings:** 0.00 SF **Missing Walls:** 0.00 SF
Floor: 3.65 SF **Ceiling:** 3.65 SF **Perim (F):** 5.58 LF **Perim (C):** 7.66 LF

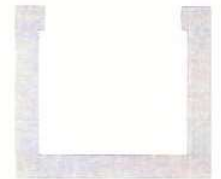

126 Drywall, Wall 1/2", Taped - Replace	48.56 (51.47)	\$2.08	SF	\$102.31	\$0.00	\$102.31
<input type="checkbox"/> Includes 6% waste on material quantity.						
127 Drywall, Ceiling 1/2", Taped - Replace	3.65 (3.83)	\$2.25	SF	\$8.29	\$0.00	\$8.29
<input type="checkbox"/> Includes 5% waste on material quantity.						
128 Texture, Ceiling Stipple - Replace	3.65	\$0.89	SF	\$3.25	\$0.00	\$3.25
129 Base Molding, Paint Grade, 3" to 6" - Replace	5.58 (5.91)	\$3.14	LF	\$18.16	\$0.91 ✓	\$17.25

Claim



QBE

QBE Americas, Inc.

PO Box 975
Sun Prairie, WI 53590 (800) 362-5448

Description	Quantity	Unit Price	Per	RC	Depreciation	ACV
ESTIMATE: Structure (Sedgwick - Atlanta, GA)						
Claim						
<input type="checkbox"/> Completed						

Includes 6% waste on material quantity.

130 Base Molding, 6" & Under - Prime & Paint	5.58	\$1.63	LF	\$9.10	\$2.28 ✓	\$6.82
131 Drywall/Plaster Ceiling - Prime	3.65	\$0.57	SF	\$2.08	\$0.00	\$2.08
132 Drywall/Plaster Ceiling - Paint, 1 Coat	3.65	\$0.60	SF	\$2.19	\$0.55 ✓	\$1.64
133 Drywall/Plaster Wall - Prime	45.21	\$0.48	SF	\$21.70	\$0.00	\$21.70
134 Drywall/Plaster Wall - Paint, 1 Coat	45.21	\$0.50	SF	\$22.61	\$5.65 ✓	\$16.96
135 Casing, Paint Grade, 3" to 5" - Replace	16.00 (16.80)	\$3.08	LF	\$50.74	\$5.07 ✓	\$45.67

Includes 5% waste on material quantity.

136 Casing - Prime & Paint	16.00	\$1.42	LF	\$22.72	\$5.68 ✓	\$17.04
137 Final Clean, per SF - Clean	3.65	\$0.17	SF	\$0.63	\$0.00	\$0.63

Pantry - Subtotal

\$243.64

Kitchen

Length: 11'4" **Width:** 11'9" **Height:** 8' Flat
Walls: 369.33 SF **Walls-subs:** 337.33 SF **Walls-subs-cas-bsbd:** 320.17 SF
Doors: 0.00 SF **Windows:** 12.00 SF **Openings:** 20.00 SF **Missing Walls:** 0.00 SF
Floor: 119.88 SF **Ceiling:** 119.88 SF **Perim (F):** 43.67 LF **Perim (C):** 43.67 LF

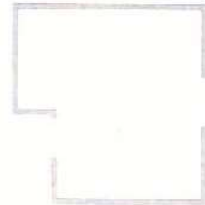

138 Drywall, Wall 1/2", Taped - Replace	337.33 (357.57)	\$2.08	SF	\$710.76	\$0.00	\$710.76
<input type="checkbox"/> Includes 6% waste on material quantity.						
139 Drywall, Ceiling 1/2", Taped - Replace	119.88 (125.87)	\$2.25	SF	\$272.42	\$0.00	\$272.42
<input type="checkbox"/> Includes 5% waste on material quantity.						
140 Texture, Ceiling Stipple - Replace	119.88	\$0.89	SF	\$106.70	\$0.00	\$106.70
141 Insulation, Wall, Batt, Unfaced 6" - Replace	172.67	\$0.92	SF	\$158.86	\$0.00	\$158.86
142 Base Molding, Paint Grade, 3" to 6" - Replace	43.67 (46.29)	\$3.14	LF	\$142.16	\$7.11 ✓	\$135.05
<input type="checkbox"/> Includes 6% waste on material quantity.						
143 Base Molding, 6" & Under - Prime & Paint	43.67	\$1.63	LF	\$71.19	\$17.80 ✓	\$53.39
144 Drywall/Plaster Ceiling - Prime	119.88	\$0.57	SF	\$68.33	\$0.00	\$68.33
145 Drywall/Plaster Ceiling - Paint, 1 Coat	119.88	\$0.60	SF	\$71.93	\$17.98 ✓	\$53.95
146 Drywall/Plaster Wall - Prime	320.17	\$0.48	SF	\$153.68	\$0.00	\$153.68
147 Drywall/Plaster Wall - Paint, 1 Coat	320.17	\$0.50	SF	\$160.09	\$40.02 ✓	\$120.07
148 Cabinet, Base (LF) Good - Replace	14.58	\$170.19	LF	\$2,481.37	\$496.27 ✓	\$1,985.10
149 Countertop, Laminate (LF) Good - Replace	14.58	\$35.20	LF	\$513.21	\$256.61 ✓	\$256.60
150 Cabinet, Wall (LF) Good - Replace	17.58	\$105.18	LF	\$1,849.06	\$369.81 ✓	\$1,479.25
151 Casing, Paint Grade, 3" to 5" - Replace	16.33 (17.15)	\$3.08	LF	\$51.79	\$5.18 ✓	\$46.61
<input type="checkbox"/> Includes 5% waste on material quantity.						
152 Casing - Prime & Paint	16.33	\$1.42	LF	\$23.19	\$5.80 ✓	\$17.39
153 Final Clean, per SF - Clean	119.88	\$0.17	SF	\$20.39	\$0.00	\$20.39

Kitchen - Subtotal

\$5,638.55



QBE

QBE Americas, Inc.

PO Box 975
Sun Prairie, WI 53590 (800) 362-5448

Description	Quantity	Unit Price	Per	RC	Depreciation	ACV
-------------	----------	------------	-----	----	--------------	-----

ESTIMATE: Structure (Sedgwick - Atlanta, GA) Claim

Completed

Closet

Length: 2'6" **Width:** 2'2" **Height:** 8' Flat
Walls: 74.66 SF **Walls-sub:** 59.66 SF **Walls-sub-cas-bsbd:** 55.27 SF
Doors: 15.00 SF **Windows:** 0.00 SF **Openings:** 0.00 SF **Missing Walls:** 0.00 SF
Floor: 5.42 SF **Ceiling:** 5.42 SF **Perim (F):** 6.84 LF **Perim (C):** 9.34 LF

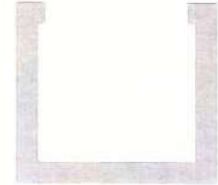

154 Drywall, Wall 1/2", Taped - Replace	59.66 (63.24)	\$2.08	SF	\$125.71	\$0.00	\$125.71
<input type="checkbox"/> Includes 6% waste on material quantity.						
155 Drywall, Ceiling 1/2", Taped - Replace	5.42 (5.69)	\$2.25	SF	\$12.32	\$0.00	\$12.32
<input type="checkbox"/> Includes 5% waste on material quantity.						
156 Texture, Ceiling Stipple - Replace	5.42	\$0.89	SF	\$4.83	\$0.00	\$4.83
157 Base Molding, Paint Grade, 3" to 6" - Replace	6.84 (7.25)	\$3.14	LF	\$22.26	\$1.11 ✓	\$21.15
<input type="checkbox"/> Includes 6% waste on material quantity.						
158 Base Molding, 6" & Under - Prime & Paint	6.84	\$1.63	LF	\$11.15	\$2.79 ✓	\$8.36
159 Drywall/Plaster Ceiling - Prime	5.42	\$0.57	SF	\$3.09	\$0.00	\$3.09
160 Drywall/Plaster Ceiling - Paint, 1 Coat	5.42	\$0.60	SF	\$3.25	\$0.81 ✓	\$2.44
161 Drywall/Plaster Wall - Prime	55.27	\$0.48	SF	\$26.53	\$0.00	\$26.53
162 Drywall/Plaster Wall - Paint, 1 Coat	55.27	\$0.50	SF	\$27.63	\$6.91 ✓	\$20.72
163 Carpet Pad, Good - Replace	5.42 (5.69)	\$0.60	SF	\$3.34	\$1.00 ✓	\$2.34
<input type="checkbox"/> Includes 5% waste on material quantity.						
164 Carpet, Wall to Wall, Good - Replace	5.42 (5.96)	\$3.64	SF	\$21.27	\$6.38 ✓	\$14.89
<input type="checkbox"/> Includes 10% waste on material quantity.						
165 Casing, Paint Grade, 3" to 5" - Replace	16.42 (17.24)	\$3.08	LF	\$52.07	\$5.21 ✓	\$46.86
<input type="checkbox"/> Includes 5% waste on material quantity.						
166 Casing - Prime & Paint	16.42	\$1.42	LF	\$23.32	\$5.83 ✓	\$17.49
167 Final Clean, per SF - Clean	5.42	\$0.17	SF	\$0.92	\$0.00	\$0.92

Closet - Subtotal

\$307.65

Storage Closet

Length: 5'10" **Width:** 8'6" **Height:** 8' Flat
Walls: 229.34 SF **Walls-sub:** 212.67 SF **Walls-sub-cas-bsbd:** 200.42 SF
Doors: 16.67 SF **Windows:** 0.00 SF **Openings:** 0.00 SF **Missing Walls:** 0.00 SF
Floor: 49.58 SF **Ceiling:** 49.58 SF **Perim (F):** 25.58 LF **Perim (C):** 28.66 LF



168 Drywall, Wall 1/2", Taped - Replace	212.67 (225.43)	\$2.08	SF	\$448.09	\$0.00	\$448.09
<input type="checkbox"/> Includes 6% waste on material quantity.						
169 Drywall, Ceiling 1/2", Taped - Replace	49.58 (52.06)	\$2.25	SF	\$112.67	\$0.00	\$112.67
<input type="checkbox"/> Includes 5% waste on material quantity.						
170 Texture, Ceiling Stipple - Replace	49.58	\$0.89	SF	\$44.13	\$0.00	\$44.13
171 Insulation, Wall, Batt, Unfaced 6" - Replace	46.67	\$0.92	SF	\$42.94	\$0.00	\$42.94



QBE

QBE Americas, Inc.

PO Box 975
Sun Prairie, WI 53590 (800) 362-5448

Description	Quantity	Unit Price	Per	RC	Depreciation	ACV
ESTIMATE: Structure (Sedgwick - Atlanta, GA)						
Completed						
Claim						

Storage Closet(con't)

172 Water Heater, Electric (MH) 40 Gallon - Rem/Reset	1	\$175.70	EA	\$175.70	\$0.00	\$175.70
173 Casing, Paint Grade, 3" to 5" - Replace	17.00 (17.85)	\$3.08	LF	\$53.91	\$5.39 ✓	\$48.52
<input type="checkbox"/> Includes 5% waste on material quantity.						
174 Casing - Prime & Paint	17.00	\$1.42	LF	\$24.14	\$6.04 ✓	\$18.10
175 Final Clean, per SF - Clean	49.58	\$0.17	SF	\$8.43	\$0.00	\$8.43

Storage Closet - Subtotal

\$898.58

Guest Bed

Length: 12' **Width:** 11' **Height:** 8' Flat
Walls: 368.00 SF **Walls-subs:** 322.67 SF **Walls-subs-cas-bsbd:** 297.33 SF
Doors: 33.34 SF **Windows:** 12.00 SF **Openings:** 0.00 SF **Missing Walls:** 0.00 SF
Floor: 132.00 SF **Ceiling:** 132.00 SF **Perim (F):** 39.88 LF **Perim (C):** 46.00 LF

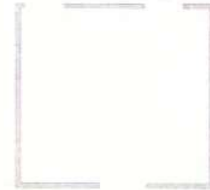

176 Base Molding, Paint Grade, 3" to 6" - Replace	39.88 (42.27)	\$3.14	LF	\$129.81	\$6.49 ✓	\$123.32
<input type="checkbox"/> Includes 6% waste on material quantity.						
177 Base Molding, 6" & Under - Prime & Paint	39.88	\$1.63	LF	\$65.01	\$16.25 ✓	\$48.76
178 Drywall/Plaster Wall - Prime	297.33	\$0.48	SF	\$142.72	\$0.00	\$142.72
179 Drywall/Plaster Wall - Paint, 1 Coat	297.33	\$0.50	SF	\$148.67	\$37.17 ✓	\$111.50
180 Carpet Pad, Good - Replace	132.00 (138.60)	\$0.60	SF	\$81.31	\$24.39 ✓	\$56.92
<input type="checkbox"/> Includes 5% waste on material quantity.						
181 Carpet, Wall to Wall, Good - Replace	132.00 (145.20)	\$3.64	SF	\$518.10	\$155.43 ✓	\$362.67
<input type="checkbox"/> Includes 10% waste on material quantity.						
182 Casing, Paint Grade, 3" to 5" - Replace	50.29 (52.80)	\$3.08	LF	\$159.47	\$15.95 ✓	\$143.52
<input type="checkbox"/> Includes 5% waste on material quantity.						
183 Casing - Prime & Paint	50.29	\$1.42	LF	\$71.42	\$17.86 ✓	\$53.56
184 Final Clean, per SF - Clean	132.00	\$0.17	SF	\$22.44	\$0.00	\$22.44

Guest Bed - Subtotal

\$1,065.41

Closet

Length: 5'10" **Width:** 2'2" **Height:** 8' Flat
Walls: 128.00 SF **Walls-subs:** 111.33 SF **Walls-subs-cas-bsbd:** 102.78 SF
Doors: 16.67 SF **Windows:** 0.00 SF **Openings:** 0.00 SF **Missing Walls:** 0.00 SF
Floor: 12.64 SF **Ceiling:** 12.64 SF **Perim (F):** 12.92 LF **Perim (C):** 16.00 LF



185 Base Molding, Paint Grade, 3" to 6" - Replace	12.92 (13.70)	\$3.14	LF	\$42.06	\$2.10 ✓	\$39.96
<input type="checkbox"/> Includes 6% waste on material quantity.						
186 Base Molding, 6" & Under - Prime & Paint	12.92	\$1.63	LF	\$21.06	\$5.27 ✓	\$15.79
187 Drywall/Plaster Wall - Prime	102.78	\$0.48	SF	\$49.33	\$0.00	\$49.33

Claim



QBE

QBE Americas, Inc.

PO Box 975
Sun Prairie, WI 53590 (800) 362-5448

Description	Quantity	Unit Price	Per	RC	Depreciation	ACV
ESTIMATE: Structure (Sedgwick - Atlanta, GA) Claim						
<input type="checkbox"/> Completed						
📁 Closet(con't)						
188 Drywall/Plaster Wall - Paint, 1 Coat	102.78	\$0.50	SF	\$51.39	\$12.85 ✓	\$38.54
189 Carpet Pad, Good - Replace	12.64 (13.27)	\$0.60	SF	\$7.79	\$2.34 ✓	\$5.45
<input type="checkbox"/> Includes 5% waste on material quantity.						
190 Carpet, Wall to Wall, Good - Replace	12.64 (13.90)	\$3.64	SF	\$49.61	\$14.88 ✓	\$34.73
<input type="checkbox"/> Includes 10% waste on material quantity.						
191 Casing, Paint Grade, 3" to 5" - Replace	17.00 (17.85)	\$3.08	LF	\$53.91	\$5.39 ✓	\$48.52
<input type="checkbox"/> Includes 5% waste on material quantity.						
192 Casing - Prime & Paint	17.00	\$1.42	LF	\$24.14	\$6.04 ✓	\$18.10
193 Final Clean, per SF - Clean	12.64	\$0.17	SF	\$2.16	\$0.00	\$2.16
Closet - Subtotal						\$252.58

📁 Utility Room

Length: 5'10" **Width:** 8'6" **Height:** 8' Flat
Walls: 229.34 SF **Walls-subs:** 212.67 SF **Walls-subs-cas-bsbd:** 200.42 SF
Doors: 16.67 SF **Windows:** 0.00 SF **Openings:** 0.00 SF **Missing Walls:** 0.00 SF
Floor: 49.58 SF **Ceiling:** 49.58 SF **Perim (F):** 25.58 LF **Perim (C):** 28.66 LF



194 Drywall, Wall 1/2", Taped - Replace	212.67 (225.43)	\$2.08	SF	\$448.09	\$0.00	\$448.09
<input type="checkbox"/> Includes 6% waste on material quantity.						
195 Drywall, Ceiling 1/2", Taped - Replace	49.58 (52.06)	\$2.25	SF	\$112.67	\$0.00	\$112.67
<input type="checkbox"/> Includes 5% waste on material quantity.						
196 Texture, Ceiling Stipple - Replace	49.58	\$0.89	SF	\$44.13	\$0.00	\$44.13
197 Insulation, Wall, Batt, Unfaced 6" - Replace	46.67	\$0.92	SF	\$42.94	\$0.00	\$42.94
198 Toilet/Water Closet 1 Piece, Good - Rem/Reset	1	\$154.48	EA	\$154.48	\$0.00	\$154.48
199 Ceramic Wall, Thin Set 4", Good - Replace	74.97 (79.47)	\$10.03	SF	\$762.39	\$228.72 ✓	\$533.67
<input type="checkbox"/> Includes 6% waste on material quantity.						
200 Cement Backer Board - Replace	74.97 (78.72)	\$3.91	SF	\$297.45	\$0.00	\$297.45
<input type="checkbox"/> Includes 5% waste on material quantity.						
201 Vanity (LF) Good - Replace	3.00	\$154.52	LF	\$463.56	\$185.42 ✓	\$278.14
202 Vanity Top, Cultured Marble, Single Bowl 3' - Replace	1	\$315.17	EA	\$315.17	\$90.04 ✓	\$225.13
203 Faucet, Bath Good - Replace	1	\$123.38	EA	\$123.38	\$82.26 ✓	\$41.12
204 P-Trap & Fittings, Sink - Replace	1	\$21.58	EA	\$21.58	\$10.79 ✓	\$10.79
205 Supply Line Sink, Flexible - Replace	2	\$17.25	EA	\$34.50	\$0.00	\$34.50
206 Casing, Paint Grade, 3" to 5" - Replace	17.00 (17.85)	\$3.08	LF	\$53.91	\$5.39 ✓	\$48.52
<input type="checkbox"/> Includes 5% waste on material quantity.						
207 Casing - Prime & Paint	17.00	\$1.42	LF	\$24.14	\$6.04 ✓	\$18.10
208 Final Clean, per SF - Clean	49.58	\$0.17	SF	\$8.43	\$0.00	\$8.43
Utility Room - Subtotal						\$2,298.16



QBE

QBE Americas, Inc.

PO Box 975
Sun Prairie, WI 53590 (800) 362-5448

Description	Quantity	Unit Price	Per	RC	Depreciation	ACV
ESTIMATE: Structure (Sedgwick - Atlanta, GA) Claim						
<input type="checkbox"/> Completed						
Master Bed						
<p>Length: 11' Width: 18'11" Height: 8' Flat</p> <p>Walls: 478.69 SF Walls-subs: 404.68 SF Walls-subs-cas-bsbd: 366.71 SF</p> <p>Doors: 50.01 SF Windows: 24.00 SF Openings: 0.00 SF Missing Walls: 0.00 SF</p> <p>Floor: 174.86 SF Ceiling: 174.86 SF Perim (F): 50.57 LF Perim (C): 59.81 LF</p>						
209 Base Molding, Paint Grade, 3" to 6" - Replace <input type="checkbox"/> Includes 6% waste on material quantity.	50.57 (53.60)	\$3.14	LF	\$164.61	\$8.23 ✓	\$156.38
210 Base Molding, 6" & Under - Prime & Paint	50.57	\$1.63	LF	\$82.43	\$20.61 ✓	\$61.82
211 Drywall/Plaster Wall - Prime	366.71	\$0.48	SF	\$176.02	\$0.00	\$176.02
212 Drywall/Plaster Wall - Paint, 1 Coat	366.71	\$0.50	SF	\$183.35	\$45.84 ✓	\$137.51
213 Carpet Pad, Good - Replace <input type="checkbox"/> Includes 5% waste on material quantity.	174.86 (183.60)	\$0.60	SF	\$107.71	\$32.31 ✓	\$75.40
214 Carpet, Wall to Wall, Good - Replace <input type="checkbox"/> Includes 10% waste on material quantity.	174.86 (192.35)	\$3.64	SF	\$686.34	\$205.90 ✓	\$480.44
215 Casing, Paint Grade, 3" to 5" - Replace <input type="checkbox"/> Includes 5% waste on material quantity.	83.66 (87.84)	\$3.08	LF	\$265.28	\$26.53 ✓	\$238.75
216 Casing - Prime & Paint	83.66	\$1.42	LF	\$118.80	\$29.70 ✓	\$89.10
217 Final Clean, per SF - Clean	174.86	\$0.17	SF	\$29.72	\$0.00	\$29.72
Master Bed - Subtotal						\$1,445.14

Utility Room

<p>Length: 5' Width: 10'9" Height: 8' Flat</p> <p>Walls: 252.00 SF Walls-subs: 235.33 SF Walls-subs-cas-bsbd: 224.19 SF</p> <p>Doors: 16.67 SF Windows: 0.00 SF Openings: 0.00 SF Missing Walls: 0.00 SF</p> <p>Floor: 53.75 SF Ceiling: 53.75 SF Perim (F): 28.71 LF Perim (C): 31.50 LF</p>						
218 Drywall, Wall 1/2", Taped - Replace <input type="checkbox"/> Includes 6% waste on material quantity.	235.33 (249.45)	\$2.08	SF	\$495.84	\$0.00	\$495.84
219 Drywall, Ceiling 1/2", Taped - Replace <input type="checkbox"/> Includes 5% waste on material quantity.	53.75 (56.44)	\$2.25	SF	\$122.15	\$0.00	\$122.15
220 Texture, Ceiling Stipple - Replace	53.75	\$0.89	SF	\$47.83	\$0.00	\$47.83
221 Insulation, Wall, Batt, Unfaced 6" - Replace	40.00	\$0.92	SF	\$36.80	\$0.00	\$36.80
222 Toilet/Water Closet 1 Piece, Good - Rem/Reset	1	\$154.48	EA	\$154.48	\$0.00	\$154.48
223 Ceramic Wall, Thin Set 4", Good - Replace <input type="checkbox"/> Includes 6% waste on material quantity.	68.54 (72.65)	\$10.03	SF	\$696.99	\$209.10 ✓	\$487.89
224 Cement Backer Board - Replace <input type="checkbox"/> Includes 5% waste on material quantity.	68.54 (71.97)	\$3.91	SF	\$271.94	\$0.00	\$271.94
225 Vanity (LF) Good - Replace	3.00	\$154.52	LF	\$463.56	\$185.42 ✓	\$278.14



QBE

QBE Americas, Inc.

PO Box 975
Sun Prairie, WI 53590 (800) 362-5448

Description	Quantity	Unit Price	Per	RC	Depreciation	ACV
ESTIMATE: Structure (Sedgwick - Atlanta, GA)						
Claim						
Completed						

Utility Room(con't)

226 Vanity Top, Cultured Marble, Single Bowl 3' - Replace	1	\$315.17	EA	\$315.17	\$90.04 ✓	\$225.13
227 Faucet, Bath Good - Replace	1	\$123.38	EA	\$123.38	\$82.26 ✓	\$41.12
228 P-Trap & Fittings, Sink - Replace	1	\$21.58	EA	\$21.58	\$10.79 ✓	\$10.79
229 Supply Line Sink, Flexible - Replace	2	\$17.25	EA	\$34.50	\$0.00	\$34.50
230 Casing, Paint Grade, 3" to 5" - Replace	9.75 (10.24)	\$3.08	LF	\$30.93	\$3.09 ✓	\$27.84
<input type="checkbox"/> Includes 5% waste on material quantity.						
231 Casing - Prime & Paint	9.75	\$1.42	LF	\$13.85	\$3.46 ✓	\$10.39
232 Final Clean, per SF - Clean	53.75	\$0.17	SF	\$9.14	\$0.00	\$9.14

Utility Room - Subtotal

\$2,253.98

Closet

Length: 2' **Width:** 4' **Height:** 8' Flat
Walls: 96.00 SF **Walls-subs:** 79.33 SF **Walls-subs-cas-bsbd:** 71.95 SF
Doors: 16.67 SF **Windows:** 0.00 SF **Openings:** 0.00 SF **Missing Walls:** 0.00 SF
Floor: 8.00 SF **Ceiling:** 8.00 SF **Perim (F):** 8.92 LF **Perim (C):** 12.00 LF



233 Base Molding, Paint Grade, 3" to 6" - Replace	8.92 (9.46)	\$3.14	LF	\$29.04	\$1.45 ✓	\$27.59
<input type="checkbox"/> Includes 6% waste on material quantity.						
234 Base Molding, 6" & Under - Prime & Paint	8.92	\$1.63	LF	\$14.54	\$3.64 ✓	\$10.90
235 Drywall/Plaster Wall - Prime	71.95	\$0.48	SF	\$34.54	\$0.00	\$34.54
236 Drywall/Plaster Wall - Paint, 1 Coat	71.95	\$0.50	SF	\$35.98	\$9.00 ✓	\$26.98
237 Carpet Pad, Good - Replace	8.00 (8.40)	\$0.60	SF	\$4.93	\$1.48 ✓	\$3.45
<input type="checkbox"/> Includes 5% waste on material quantity.						
238 Carpet, Wall to Wall, Good - Replace	8.00 (8.80)	\$3.64	SF	\$31.40	\$9.42 ✓	\$21.98
<input type="checkbox"/> Includes 10% waste on material quantity.						
239 Final Clean, per SF - Clean	8.00	\$0.17	SF	\$1.36	\$0.00	\$1.36

Closet - Subtotal

\$126.80

Utility Room

Length: 8' **Width:** 9'8" **Height:** 8' Flat
Walls: 282.66 SF **Walls-subs:** 262.66 SF **Walls-subs-cas-bsbd:** 253.09 SF
Doors: 0.00 SF **Windows:** 0.00 SF **Openings:** 20.00 SF **Missing Walls:** 0.00 SF
Floor: 77.33 SF **Ceiling:** 77.33 SF **Perim (F):** 32.84 LF **Perim (C):** 32.84 LF

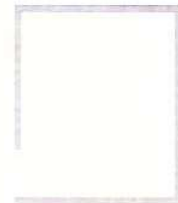

240 Base Molding, Paint Grade, 3" to 6" - Replace	32.84 (34.81)	\$3.14	LF	\$106.90	\$5.35 ✓	\$101.55
<input type="checkbox"/> Includes 6% waste on material quantity.						
241 Base Molding, 6" & Under - Prime & Paint	32.84	\$1.63	LF	\$53.53	\$13.38 ✓	\$40.15
242 Drywall/Plaster Ceiling - Prime	77.33	\$0.57	SF	\$44.08	\$0.00	\$44.08



QBE

QBE Americas, Inc.PO Box 975
Sun Prairie, WI 53590 (800) 362-5448

Description	Quantity	Unit Price	Per	RC	Depreciation	ACV
ESTIMATE: Structure (Sedgwick - Atlanta, GA)						
Claim						
<input type="checkbox"/> Completed						
<input type="checkbox"/> Utility Room(con't)						
243 Drywall/Plaster Ceiling - Paint, 1 Coat	77.33	\$0.60	SF	\$46.40	\$11.60 ✓	\$34.80
244 Drywall/Plaster Wall - Prime	253.09	\$0.48	SF	\$121.49	\$0.00	\$121.49
245 Drywall/Plaster Wall - Paint, 1 Coat	253.09	\$0.50	SF	\$126.55	\$31.64 ✓	\$94.91
246 Carpet Pad, Good - Replace	77.33 (81.20)	\$0.60	SF	\$47.63	\$14.29 ✓	\$33.34
<input type="checkbox"/> Includes 5% waste on material quantity.						
247 Carpet, Wall to Wall, Good - Replace	77.33 (85.06)	\$3.64	SF	\$303.51	\$91.05 ✓	\$212.46
<input type="checkbox"/> Includes 10% waste on material quantity.						
248 Casing, Paint Grade, 3" to 5" - Replace	0.00	\$3.08	LF	\$0.00	\$0.00	\$0.00
<input type="checkbox"/> Includes 5% waste on material quantity.						
249 Casing - Prime & Paint	0.00	\$1.42	LF	\$0.00	\$0.00	\$0.00
250 Final Clean, per SF - Clean	77.33	\$0.17	SF	\$13.14	\$0.00	\$13.14
Utility Room - Subtotal						\$695.92
Unit 2505 - Subtotal						\$22,882.03



QBE

QBE Americas, Inc.PO Box 975
Sun Prairie, WI 53590 (800) 362-5448**ESTIMATE: Structure (Sedgwick - Atlanta, GA) Claim**

Completed

Total Materials:	\$15,541.94
Total Labor:	\$17,649.14
Total Equipment:	\$176.32
Total Market Conditions:	\$0.00
Subtotal:	\$33,367.40
Add 10.00% overhead:	\$3,336.73
Add 10.00% profit:	\$3,336.73
Subtotal:	\$40,040.86
Sales Tax 6.000% (applies to materials, equipment and O&P):	\$1,131.80
Replacement Cost Value:	\$41,172.66
Replacement Cost on Coverage Unit 2503:	\$7,508.82
Less Recoverable Depreciation (includes taxes):	\$(1,007.32)
Net ACV on Coverage Unit 2503:	\$6,501.50
Amount Payable on Coverage Unit 2503:	\$6,501.50
Net Coverage Unit 2503 after Deductible if Depreciation Is Recovered:	\$7,508.82
Amount Payable on Coverage Unit 2503 if Depreciation Is Recovered:	\$7,508.82
Replacement Cost on Coverage Unit 2505:	\$33,663.84
Less Recoverable Depreciation (includes taxes):	\$(4,571.76)
Net ACV on Coverage Unit 2505:	\$29,092.08
Amount Payable on Coverage Unit 2505:	\$29,092.08
Net Coverage Unit 2505 after Deductible if Depreciation Is Recovered:	\$33,663.84
Amount Payable on Coverage Unit 2505 if Depreciation Is Recovered:	\$33,663.84
Net Estimate:	\$35,593.58
Total Net Recoverable Depreciation:	\$5,579.08
Net Estimate if Depreciation Is Recovered:	\$41,172.66

Finalization



QBE Americas, Inc.
PO Box 975
Sun Prairie, WI 53590 (800) 362-5448

Estimate Addendum

Claim No.:

Insured:

This is an estimate to repair damage from your recent claim. Should you have any questions, please call your claims professional.

Date 12/13/19